

“Y” TYPE CONTROL VALVE



2/2 Way Pneumatic On - Off “Y” Type Control Valve.

Normally close type and Normally open type

M.O.C.

- S.S 316(ASTM-A351 CF8M)
- S.S.304(ASTM-A-351 Gr.CF8)
- C.S.(ASTM-A-216 GR.WCB)

Manufacturing Range : ½” (15mm) to 2” (50mm)
Ends : Screwed to BSP Female.

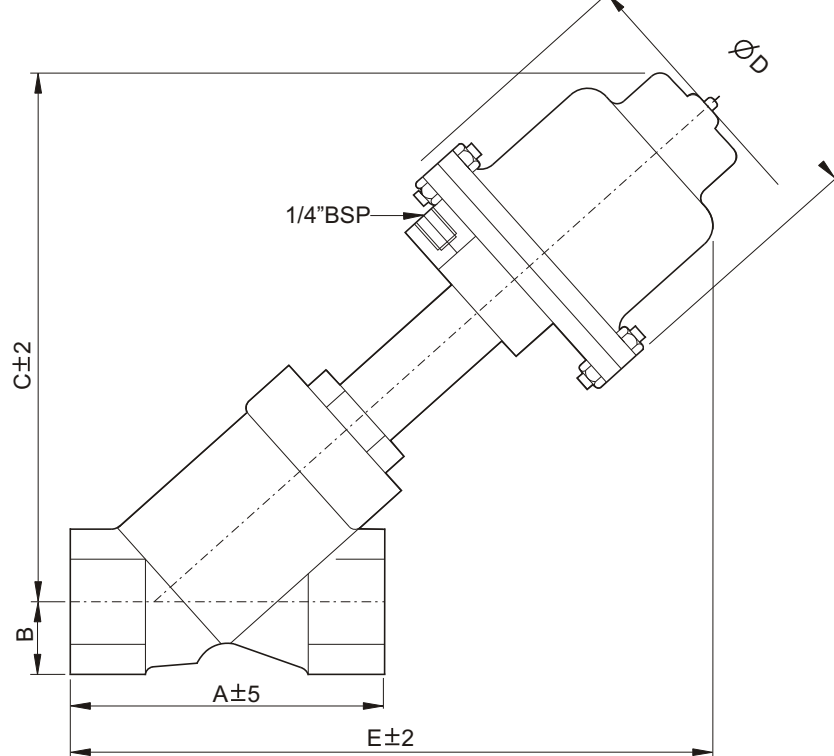

VALVE OVERALL DIMENSIONS					
SIZE	15	20	25	40	50
A	64	74	89	125	150
B	17	19	22	29	37
C	165	172	180	182	-
∅D	110	110	110	110	110
E	183	190	200	223	-
WT.KG.	1.5	1.85	2.5	2.9	4.1

Luthra Hydro Pneumatic Industries, Mumbai