

AR16-TME

TAPER MALE ELBOW

PART NO.	MM OD	R NPT(M)	T	A	C	A/F	N	L	T1
AR16-TME0318	3	1/8	23.6	9.6	2.4	11	11	17	17.8
AR16-TME0314	3	1/4	24.6	14.3	2.4	14	11	18	23.4
AR16-TME0618	6	1/8	27	9.6	4.8	14	14	19.6	18.8
AR16-TME0614	6	1/4	27	14.3	4.8	14	14	19.6	23.4
AR16-TME0638	6	3/8	29.8	14.3	4.8	17	14	22.4	26.2
AR16-TME0612	6	1/2	31.8	19.1	4.8	22	14	24.4	33
AR16-TME0818	8	1/8	28.8	9.6	4.8	14	16	21.3	19.8
AR16-TME0814	8	1/4	28.8	14.3	6.3	14	16	21.3	24.4
AR16-TME0838	8	3/8	30.6	14.3	6.3	17	16	23.1	26.2
AR16-TME0812	8	1/2	32.6	19.1	6.3	22	16	25.1	33
AR16-TME1014	10	1/4	31.5	14.3	7.1	17	19	23.9	26.2
AR16-TME1038	10	3/8	31.5	14.3	7.9	17	19	23.9	26.2
AR16-TME1012	10	1/2	33.5	19.1	7.9	22	19	25.9	33
AR16-TME1214	12	1/4	36	14.3	7.1	22	22	25.9	26.2
AR16-TME1238	12	3/8	36	14.3	9.5	22	22	25.9	28.2
AR16-TME1212	12	1/2	36	19.1	9.5	22	22	25.9	33
AR16-TME1512	15	1/2	38	19.1	11.9	24	25	27.9	35.1
AR16-TME1612	16	1/2	38	19.1	11.9	24	25	27.9	35.1
AR16-TME1634	16	3/4	39.8	19.1	11.9	24	25	29.7	36.8
AR16-TME2234	22	3/4	44.6	19.1	15.9	35	32	34.5	41.7
AR16-TME2201	22	1	44.6	23.9	18.3	35	32	34.5	46.5
AR16-TME2534	25	3/4	49.1	19.1	19.9	35	38	36.8	41.7
AR16-TME2501	25	1	49.1	23.9	21.8	35	38	36.8	46.5

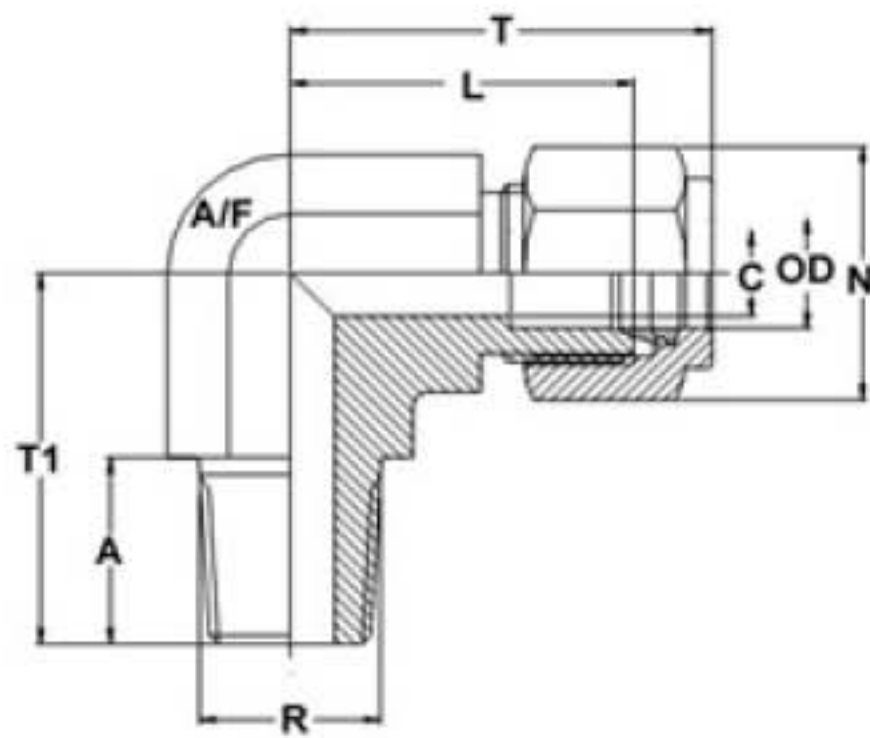

AR18-TME

TAPER MALE ELBOW

PART NO.	INCH OD	R NPT(M)	T	A	C	A/F	N	L	T1
AR18-TME1818	1/8	1/8	23.6	9.6	2.4	11	11	17	17.8
AR18-TME1814	1/8	1/4	24.6	14.3	2.4	14	11	18	23.4
AR18-TME1418	1/4	1/8	26.9	10.4	4.8	14	14	19.6	19
AR18-TME1414	1/4	1/4	29.7	15	4.8	19	14	22.4	22.4
AR18-TME1438	1/4	3/8	31.8	15	4.8	22	14	24.4	22.4
AR18-TME1412	1/4	1/2	34.6	19.8	4.8	27	14	27.2	28.5
AR18-TME3818	3/8	1/8	30.5	9.6	4.8	14	17	23.2	19.1
AR18-TME3814	3/8	1/4	30.5	14.3	7.1	17	17	23.2	19.1
AR18-TME3838	3/8	3/8	31.2	15	7.1	17	17	23.9	22.4
AR18-TME3812	3/8	1/2	33.3	15	7.1	22	17	25.9	22.4
AR18-TME1214	1/2	1/4	36	14.3	4.8	22	22	25.9	28.2
AR18-TME1238	1/2	3/8	36	14.3	9.6	22	22	25.9	28.2
AR18-TME1212	1/2	1/2	36	19.1	10.4	22	22	25.9	33
AR18-TME1234	1/2	3/4	39.9	19.1	10.4	27	22	29.7	36.8
AR18-TME3412	3/4	1/2	39.9	19.1	11.9	27	29	29.7	36.8
AR18-TME3434	3/4	3/4	39.9	19.1	15.8	27	29	29.7	36.8
AR18-TME0134	1	3/4	49	19.1	15.8	35	38	36.8	41.6
AR18-TME0101	1	1	49	23.8	22.3	35	38	36.8	46.5