

MIDGET CYLINDER



Series - T cylinders are available in bore sizes of 8mm/12mm, 20mm & 25mm. Higher bore sizes of upto 40mm are available on request. These cylinders have improved aesthetic quality as compared to Tie rod mounted cylinder. Also as the front cover is threaded to the tube, seals can be easily replaced. Cylinder can be directly neck mounted as the front / rear covers are threaded reducing system installation time.

TECHNICAL CHARACTERISTICS



Working Pressure : 1 to 10 bar
Ambient Temperature : -20 to 80°C
Fluid : filtered air / water
Barrel : Brass
End Caps : Aluminium
Piston : Aluminium
Piston Rods : En8 Hard chrome plated
Seals : Nitrile

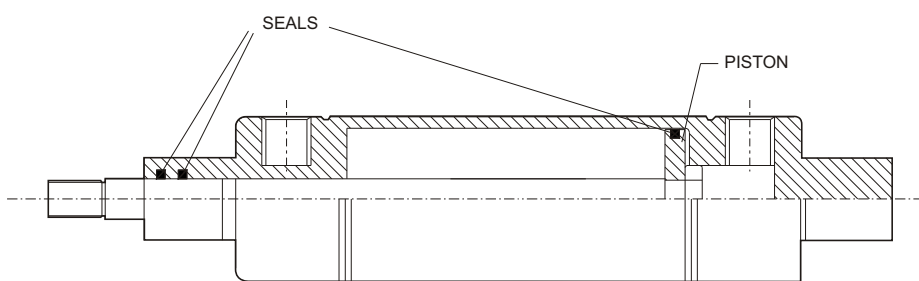

MIDGET CYLINDER

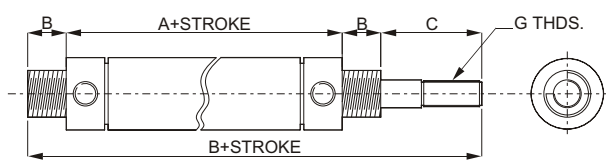

Bore	A	b	F	c	G thds.	H thds.	B
19	70	14	55	22	M 15X1.5	M 6X1	120
25	72	14	55	22	M 20X1.5	M8X1.25	124

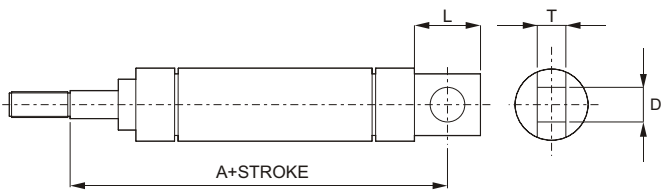

Bore	L	T	D	A
19	18	8	6	
25	25	12	12	107

